

310 PIGGOTT CRESCENT SASKATOON, SASKATCHEWAN

DRAWING INDEX

ARCHITECTURAL

- A0.0 TITLE SHEET,
DRAWING INDEX,
SITE PLAN
- A1.0 MAIN FLOOR PLAN
- A1.1 PARTIAL MAIN FLOOR PLAN
- A1.2 PARTIAL MAIN FLOOR PLAN

ZONING: IH, THROUGH SITE
 SITE AREA = 33,972 M²
 SITE COVERAGE = 55.4%

COS EASEMENT, SOUTH R
 = 8.0M (26'-3")
 = 3.0M (10'-0")
 COS EASEMENT, WEST R
 = 19.114.0M (63'-0")
 COS EASEMENT, EAST R
 = 5.0M (15'-0")

FRONT YARDS = 6.0M (20')
 SIDE YARDS = 0
 REAR YARD = 0

LANDSCAPE STRIPS:
 = FRONT, 4.5M (15')

PARKING CALCULATION:

TOTAL BUILDING AREA = 202,500 FT²
 = 18,813 M²

TOTAL SPOTS REQUIRED = 18,813/93
 = 203 SPOTS

TOTAL SPOTS PROVIDED = 185 SPOTS
 (2 ACCESSIBLE SPOTS PROVIDED)

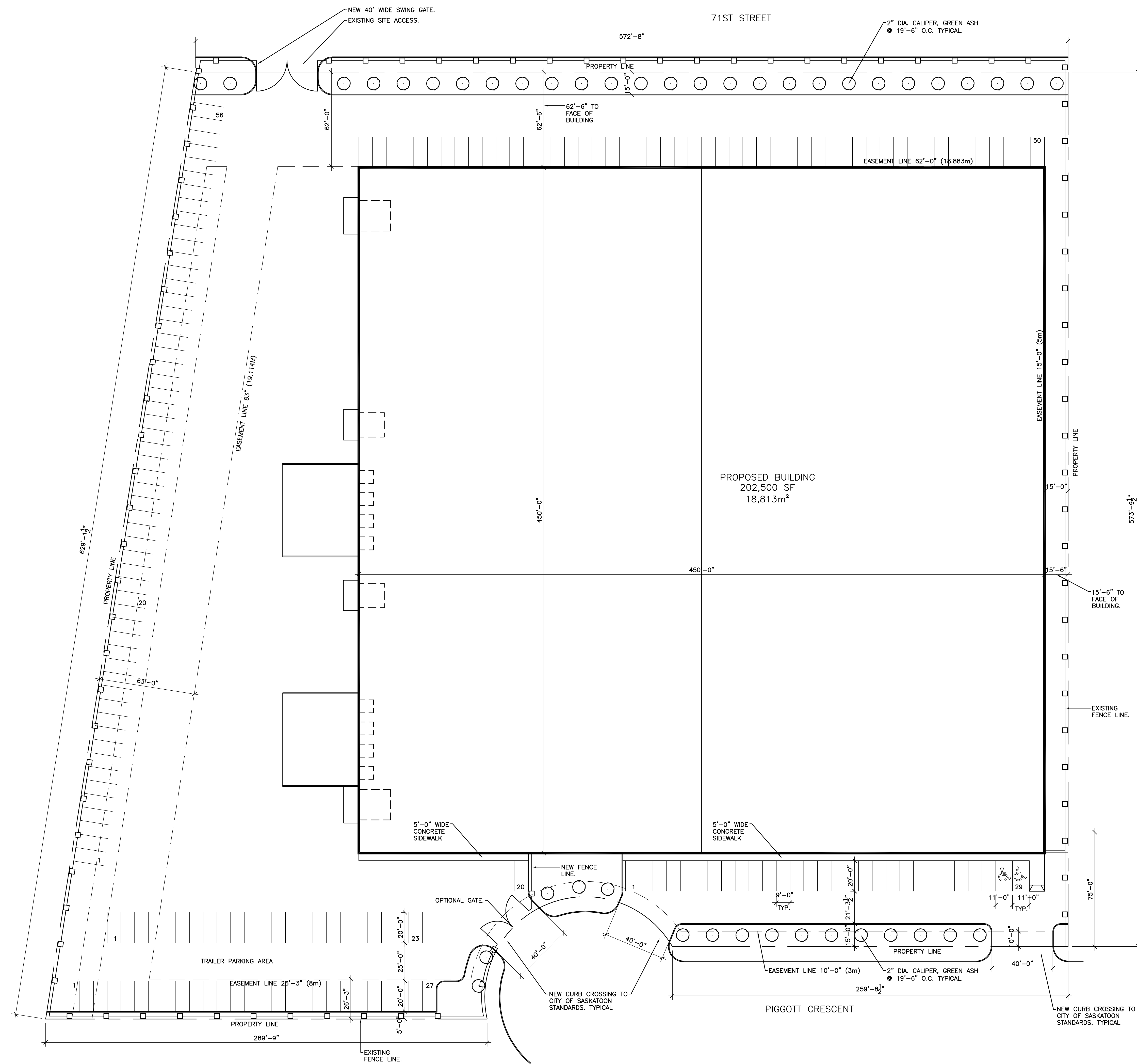

NORTH
 1 SITE PLAN
 SCALE 1/32"=1'-0"

THIS DRAWING MUST NOT BE SCALED.
 GENERAL CONTRACTOR SHALL VERIFY ALL DIMENSIONS, DATA AND LEVELS PRIOR TO COMMENCING WORK. ALL ERRORS AND OMISSIONS SHALL BE REPORTED TO THE ARCHITECT IMMEDIATELY.
 VARIATIONS AND MODIFICATIONS TO WORK SHOWN ON THESE DRAWINGS SHALL NOT BE CARRIED OUT WITHOUT THE WRITTEN PERMISSION OF THE ARCHITECT.
 ALL DRAWINGS AND SPECIFICATIONS ARE INSTRUMENTS OF SERVICE AND PROPERTY OF THE ARCHITECT AND SHALL NOT BE USED WITHOUT THE ARCHITECT'S PERMISSION. THESE DRAWINGS MUST BE PROPERLY SEALED WHEN USED TO APPLY FOR A BUILDING PERMIT.

PRELIMINARY
 NOT FOR CONSTRUCTION

REV#	COMMENTS	DATE

EDWARDS EDWARDS McEWEN
 ARCHITECTS
 203 AVENUE B NORTH
 SASKATOON, SASKATCHEWAN
 S7L 1E2
 PHONE: (306) 343-6600
 FAX: (306) 374-1643
 ecm@sasked.net

PROJECT:
310 PIGGOTT CRESCENT
 SASKATOON, SASKATCHEWAN

CONTENTS:
**TITLE SHEET,
 DRAWING INDEX,
 SITE PLAN**

DRAWN: JO
 CHECKED: DCE
 FILE: 6052
 SHEET NO:
A0.0