

THIS DRAWING MUST NOT BE SCALED.

GENERAL CONTRACTOR SHALL VERIFY ALL DIMENSIONS, DATA AND LEVELS PRIOR TO COMMENCING WORK. ALL ERRORS AND OMISSIONS SHALL BE REPORTED TO THE ARCHITECT IMMEDIATELY.

VARIATIONS AND MODIFICATIONS TO WORK SHOWN ON THESE DRAWINGS SHALL NOT BE CARRIED OUT WITHOUT THE WRITTEN PERMISSION OF THE ARCHITECT.

ALL DRAWINGS AND SPECIFICATIONS ARE INSTRUMENTS OF SERVICE AND PROPERTY OF THE ARCHITECT AND SHALL NOT BE USED WITHOUT THE ARCHITECT'S PERMISSION. THESE DRAWINGS MUST BE PROPERLY SEALED WHEN USED TO APPLY FOR A BUILDING PERMIT.

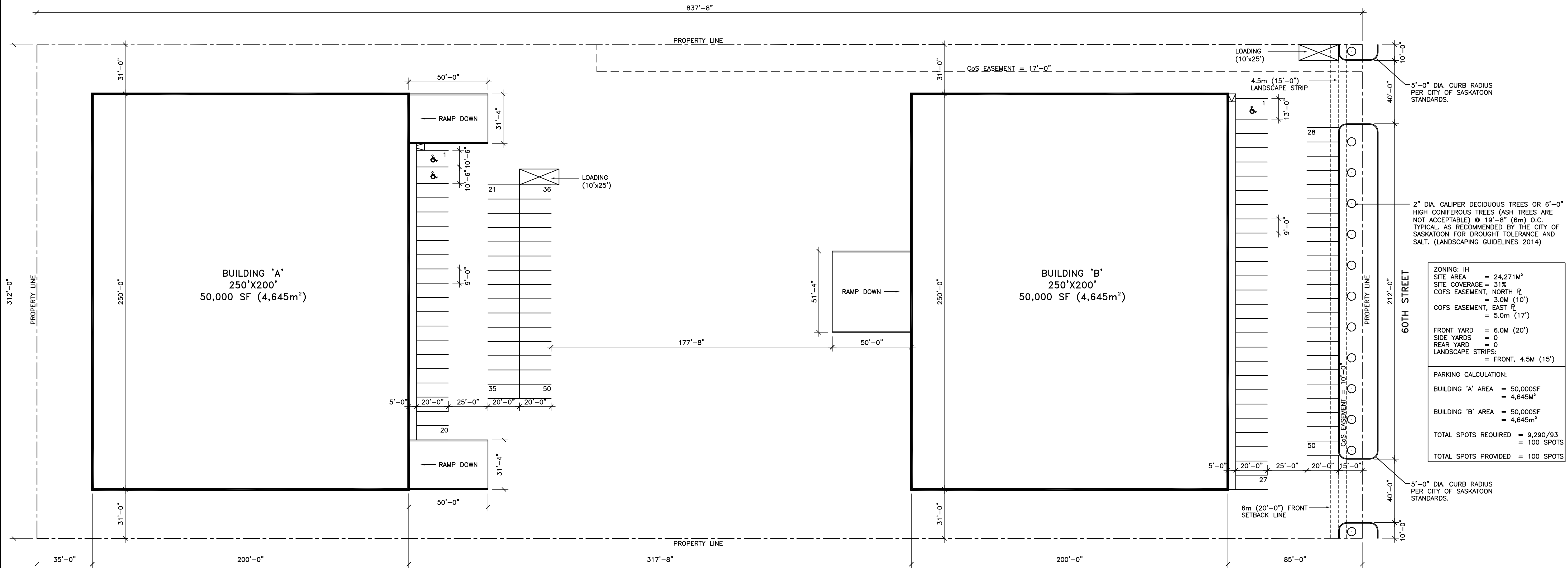

ZONING: IH	
SITE AREA	= 24,271m <sup>2</sup>
SITE COVERAGE	= 31%
COFS EASEMENT, NORTH R	= 3.0M (10')
COFS EASEMENT, EAST R	= 5.0M (17')
FRONT YARD	= 6.0M (20')
SIDE YARDS	= 0
REAR YARD	= 0
LANDSCAPE STRIPS:	= FRONT, 4.5M (15')
PARKING CALCULATION:	
BUILDING 'A' AREA	= 50,000SF
	= 4,645M <sup>2</sup>
BUILDING 'B' AREA	= 50,000SF
	= 4,645M <sup>2</sup>
TOTAL SPOTS REQUIRED	= 9,290/93
	= 100 SPOTS
TOTAL SPOTS PROVIDED	= 100 SPOTS

NORTH

1 SITE PLAN

SCALE 1/32"=1'-0"

PRELIMINARY  
NOT FOR CONSTRUCTION

REV/N	COMMENTS	DATE

EDWARDS EDWARDS McEWEN  
ARCHITECTS

202 AVENUE B NORTH  
SASKATOON, SASKATCHEWAN  
S7L 1E2

PHONE: (306) 343-6000  
FAX: (306) 374-1661  
ecm@saet.net

PROJECT:  
**834 60TH STREET**  
**834 60TH STREET**  
**SASKATOON, SASKATCHEWAN**

CONTENTS:  
**SITE PLAN**

DRAWN: JO  
CHECKED: DE  
DATE: AUGUST 2022  
FILE: 6820

SHEET NO:  
**A0.0**